

GripLock Finger™

Instructions For Use
Class 1 Prosthetic Device
PPF101 | First Generation

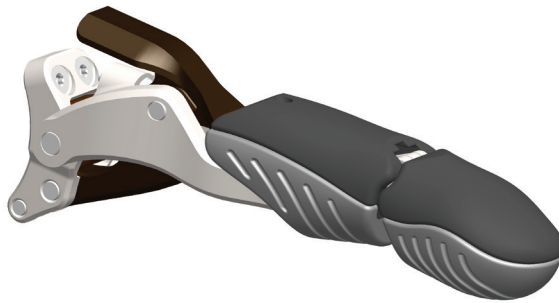

Manufacturer	Authorized Representative		
 <p>Naked Prosthetics 408 Olympia Ave NE Olympia, WA 98501 USA +1 (360) 915-9724 Manufactured in the USA</p>	<table border="1"><tr><td data-bbox="558 1850 680 1946">EC</td><td data-bbox="680 1850 802 1946">REP</td></tr></table> <p>EMERGO EUROPE Prinsessegracht 20 2514 AP The Hague The Netherlands</p>	EC	REP
EC	REP		

ENGLISH



Medical Device

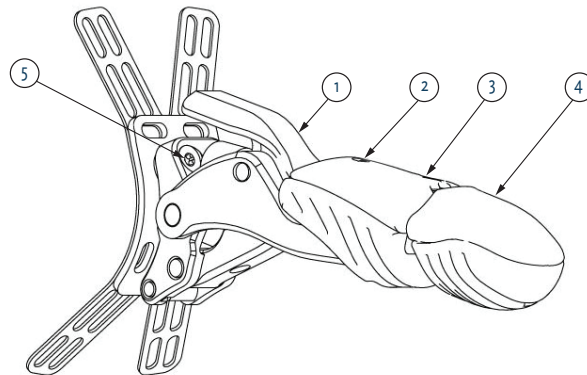

Figure: A

LIST OF PARTS

Figure A:

- | | | |
|------------------------|----------------------------|--------------|
| ① Pawl (release lever) | ② Fairing Attachment Screw | ③ P2 Fairing |
| ④ GLF Tip | ⑤ Anchor Attachment Screws | |

PRODUCT DESCRIPTION

The **GripLock Finger** is a passive, locking, mechanical prosthesis that aims to restore hand function to patients with complete finger amputations or congenital anomalies. The **GripLock Finger** replaces the absent digits to allow users to regain prehension and functional grasp patterns. Restoring force opposition and length to the affected fingers, it also helps to protect the amputation site and resist painful forces at the end of residuum. The **GripLock Finger** works as a positionable, locking, mechanical finger. Once flexed, there are two methods of returning it to its neutral position: (1) by depressing the Pawl located at the dorsal side (*Figure A, 1*) of the **GripLock Finger** or (2) by fully flexing the **GripLock Finger** until the reset position is reached and then allowing it to release. The **GripLock Fingers** are intended to be used in conjunction with a custom-fabricated socket and to be fit on a patient by a certified prosthetic clinician.

Usage Recommendations

When using the **GripLock Finger**, it is recommended to gradually build up to full-time use. This will help prevent overuse injuries in muscles that may have been underutilized until this point.

Occupational, rehabilitation, or hand therapy is recommended after receiving your device for muscle strengthening and optimal function of the device.

Caution

- For patients with sensitivity, it is recommended to use the **GripLock Finger** as tolerated.
- If redness or irritation appears on your skin, decrease usage of your device.
- If redness persists or discomfort arises, stop usage of the device immediately and contact your Prosthetist.

Serious incidents should be reported to Naked Prosthetics and appropriate government authorities in which the user and/or patient is established.

Device Maintenance

- The GripLock Finger is waterproof; dirt, chemical and heat resistant, and built for use.
- Prolonged exposure to strong solvents may damage painted surfaces.
- Working regularly with degreasers may strip lubrication from hinges.
- Contact your Prosthetist to facilitate servicing or replacement components.
- To ensure the longevity of the GripLock Finger, apply a food-safe, light mineral oil to the following locations:

Figure B:

- ① Spring
- ② Pawl Interface
- ③ Pawl Hinge
- ④ Teeth

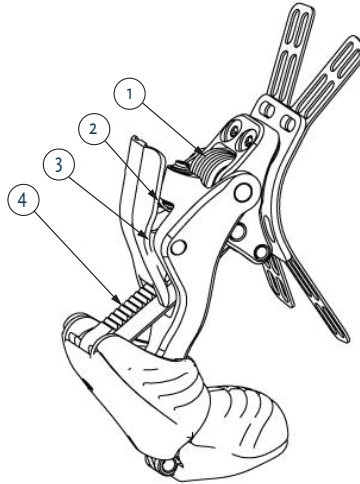

* *NOTE: For safety reasons, hinges should only be disassembled by the device manufacturer.*

Care & Cleaning

- Prolonged exposure to strong solvents may damage painted surfaces and remove hinge lubrication.
- Rinse with fresh water after use in saltwater.
- Clean device with warm water and mild detergent as necessary. Pat- or air-dry.
- Clean dirt or grime from the device using an old toothbrush or compressed air if desired.
- Do NOT machine wash; Do NOT place in dryer.

Warranty

Naked Prosthetics offers a standard 1-year warranty (from ship date) on the mechanical function of the GripLock Finger. Please contact Naked Prosthetics for additional, extended warranty options.

Change in Performance

In the event of change in performance of a device, always cease using device and contact your clinic.



Warning: Do not use device if contact between device and patient's skin is causing pain, excessive abrasion, or bleeding.

For more information: visit npdevices.com

Report of Serious Incident

Any serious incident in relation to the device must be reported to the manufacturer and relevant authorities.

Disposal

The device and packaging must be disposed of in accordance with respective local or national environmental regulations.

Liability

Naked Prosthetics does not assume liability for the following:

- Device not maintained as instructed by the instructions for use.
- Device assembled with components from other manufacturers.
- Device used outside of recommended use condition, application, or environment

For more information: visit npdevices.com